

# Truck Scale Bronze Package

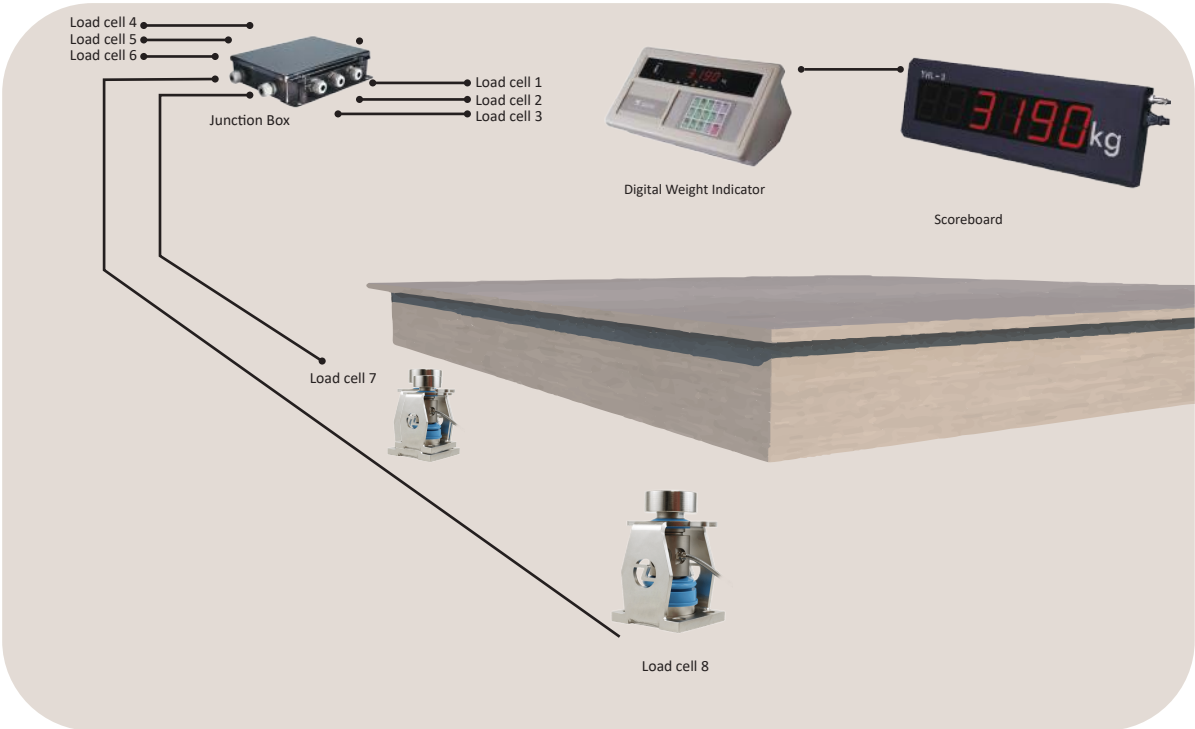

## Features

The Truck Scale Bronze Package is a comprehensive system designed for accurate and efficient weighing of trucks in industrial, commercial and logistics operations.

It combines robust hardware components to ensure precise weight measurements, reliability, and user-friendly operation.

## Functions

- Superior Accuracy
- Durability and Robustness
- Enhanced Efficiency
- User-Friendly Interface
- Cost-Effective Solution
- Advanced Signal Processing
- Regulatory Compliance
- Versatile Applications

Devices	Number of items
Zemic HM14H Load Cell	8
Zemic JB06 Junction Box	1
Yaohua A9 Indicator	1
Yaohua YHL-3 Scoreboard	1

# Type HM14H1 Load Cell



## Short description



- Nickel plated alloy steel IP68 column load cell
- Hermetically sealed
- Suitable for truck, track, hopper and other electronic weighing devices
- High accuracy



Test certificate no. TC8228 Revision 0  
C of C no R60/2000-NL1-12.46

## Available models

Capacity	Accuracy	Full article description
20t	C3	HM14H1-C3-20t-20B-W1
30t	C3	HM14H1-C3-30t-20B-W1
40t	C3	HM14H1-C3-40t-20B-W1
50t	C3	HM14H1-C3-50t-20B-W1

Specifications and dimensions are subject to change without notice and do not constitute any liability

# Type HM14H1 Load Cell

## Technical specifications HM14H1

Accuracy class		C3
Output sensitivity ( = FS )	mV/V	$2.0 \pm 0.002$
Maximum capacity ( $E_{max}$ )	t	20, 30, 40, 50
Max. number of load cell intervals	$n_{LC}$	3000
Ratio of min. LC verification interval	$Y = E_{max} / v_{min}$	10000
Combined Error	%FS	$\leq \pm 0.02$
Minimum dead load	Of $E_{max}$	0%
Safe overload	of $E_{max}$	150 %
Ultimate overload	of $E_{max}$	300 %
Zero balance	of FS	$< \pm 1.0 \%$
Excitation, recommended voltage	V	5 ~ 12
Excitation maximum	V	18
Input resistance	$\Omega$	$700 \pm 7$
Output resistance	$\Omega$	$703 \pm 4$
Insulation resistance	M $\Omega$	$\geq 5000$ ( at 50VDC )
Compensated temperature	°C	-10 ~ +40
Operating temperature	°C	-35 ~ +65
Storage temperature	°C	-40 ~ +70
Element material		Nickel plated alloy steel
Ingress Protection (acc. to EN 60529)		IP68

## Wiring

### Features:

Shielded, 4 conductor cable  
Cable diameter:  $\varnothing 5.0\text{mm}$   
Standard cable length: 20m  
Shield not connected to element

### 4-wire diagram

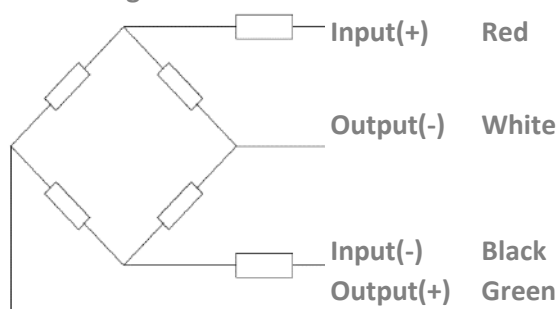

Specifications and dimensions are subject to change without notice and do not constitute any liability

# Type HM14H1 Load Cell

Dimensions in mm

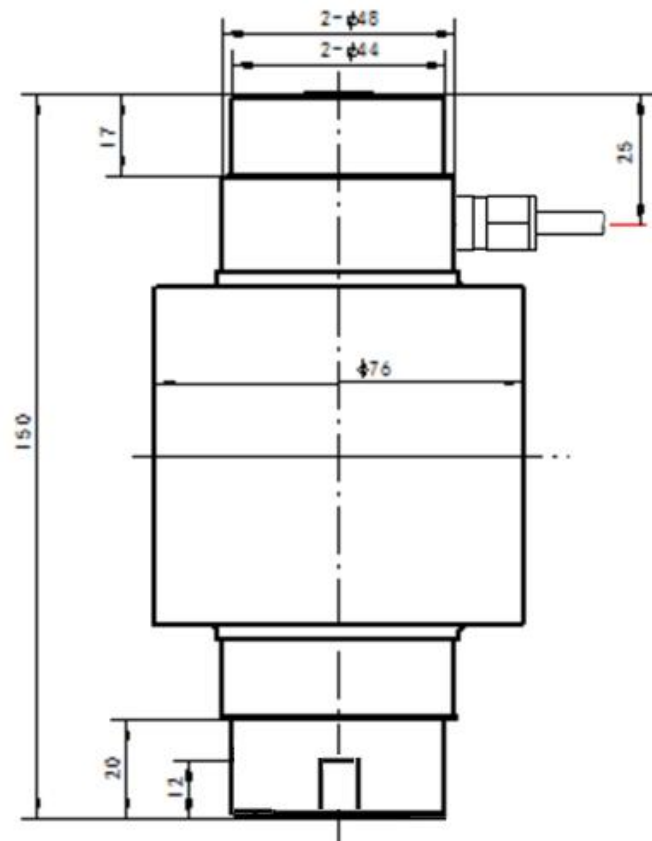

## Available accessories

### HY-14-146-20-50t rocker support

- 1 piece, top, with mounting holes
- 1 piece, bottom, with mounting holes
- Alloy steel
- Anti-rotation pin in the bottom base
- Including washers for positioning

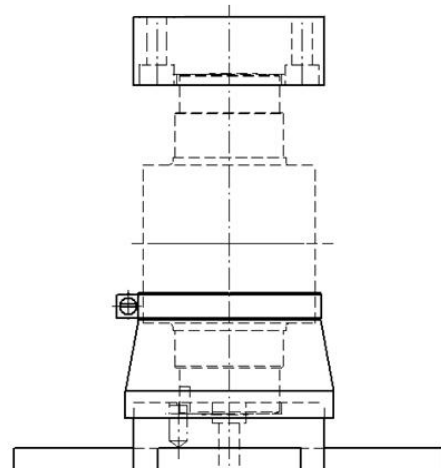

Specifications and dimensions are subject to change without notice and do not constitute any liability



Short Description



- Junction Box, fit for 4-wire and 6-wire load cells
- Cast aluminium housing, grey powdercoated
- Easy installation
- Surge protection

Available Models

Model	Amount of Connections	Full Article Description	Part Number
JB06C	3	JB06C-3	30060200
	4	JB06C-4	30060300
	6	JB06C-6	30060400
	8	JB06C-8	30060500

Detailed Specifications JB06

Load Cell Output Resistance Range	$\Omega$	340 to 1100
Load Cell Input Resistance Range	$\Omega$	340 to 1100
Excitation, Recommended Voltage	V(AC & DC)	5 to 17
Excitation, Maximum Voltage	V(AC & DC)	18
Load Cell Sensitivity Range	mV/V	0.6 – 3
Cable Diameter $\varnothing$	mm	5 - 6.2
Correction Method		Signal trim
Trimming Range	$\Omega$	14
Temperature Range, Operating	$^{\circ}\text{C}$	-40 ~ +85
Ingress Protection		IP66
Housing Connected to Shield		Yes
External Grounding		Yes



# Type JB06 Junction Box

## Dimensions in mm

Front View

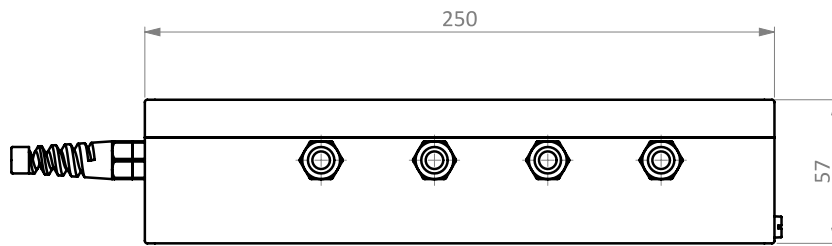

Connections



Top View

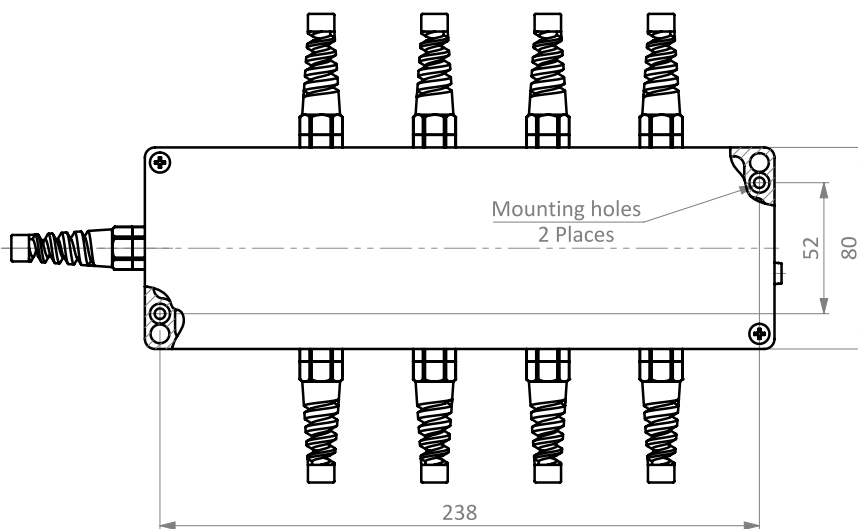

Side View

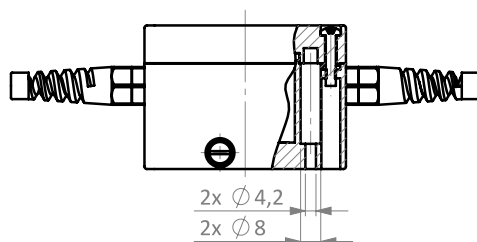

Isometric View

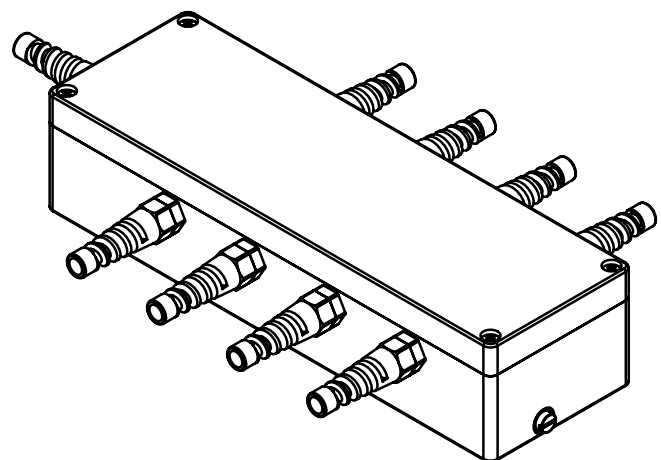



# Truck Scale Indicator



**A9+P**

With micro-printer



A9+  
b type Plastic Housing  
With outside rechargeable battery

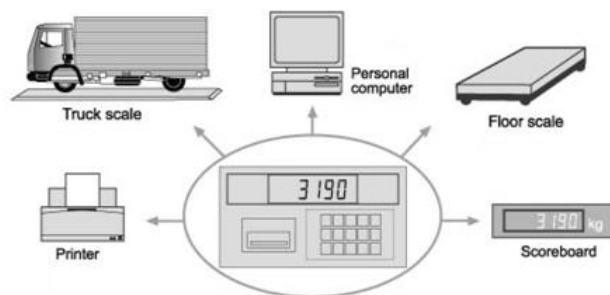
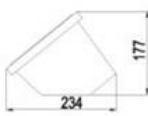
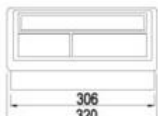

## Introduction:

Weighing indicator XK3190-A9+ adopts high precision  $\Sigma-\Delta$  A/D conversion technology, widely applied in electronic floor scale, electronic truck scale and so on alike static weighing system.

## Feature:

- ◆ Compatible with all functions of model XK3190-A9;
- ◆  $\Sigma-\Delta$  high precision A/D conversion method, able to process input signal from  $-16\text{mV}$  to  $18\text{mV}$
- ◆ Good consistency, no need to re-calibrate a scale if change the former indicator, high precision
- ◆ DC power socket with anti-connect and anti-short circuit protection;
- ◆ With strong anti-disturbance function

## Standard Function:

- ◆ AC/DC power supply, standard chargeable battery
- ◆ 7-bits 0.8 inch LED display, 3-level battery indications
- ◆ Able to setup zero-tracking range, zero(auto/manual) range
- ◆ With 2-point calibration correction function, 2 compensation calibration methods
- ◆ Able to save 1001 weighing records, 1000 truck records consisting of truck ID and corresponding tare weight, 201 records of goods
- ◆ Able to print across and upright weighing bill
- ◆ Able to print different statistical reports
- ◆ Standard RS232 communication interface(RS422/RS485 optional)
- ◆ Standard scoreboard interface with current loop
- ◆ Standard parallel print interface
- ◆ Able to connect assigned thermal printer
- ◆ XK3190-A9+P with built in printer

## Technical Parameter:

- ◆ A/D conversion method:  $\Sigma-\Delta$
- ◆ Input signal range:  $-16\text{mV} \sim 18\text{mV}$
- ◆ A/D conversion speed: 10times/sec.
- ◆ A/D conversion code: 1 million code
- ◆ Load cell excitation: DC 5V
- ◆ Max. connection number of load cell: 8 at 350 ohm/16 at 700 ohm
- ◆ Load cell connection mode: 6 wire, auto compensation for long distance
- ◆ Division: 1/2/5/10/20/50/100 optional
- ◆ Clock: real clock without effect when power off
- ◆ Transimission: current loop/RS 232 signal
- ◆ Baud rate:600
- ◆ Transimission distance:  $\leq 30$  meters
- ◆ Serial communication:interface
- ◆ Transimission method:RS232/RS422(optional)/RS485(optional)
- ◆ Baund rate:600/1200/2400/4800/9600(optional)
- ◆ Transmission distance:RS232:  $\leq 30$  meters;RS422/RS485:  $\leq 1200$  meters
- Print interface
- ◆ Standard parallel output interface
- ◆ Built-in micro-printer(A9+P)
- ◆ Data storage: 1000 truck records consisting of truck ID and corresponding tare weight 201 cargo ID.1001 weighting records
- ◆ Power supply:AC 2220( $-15\% \sim +10\%$ );50hZ( $-2\% \sim +2\%$ )
- DC 6V/10Ah External battery rechargeable





# Scoreboard

# YHL



Common type **YHL-3**

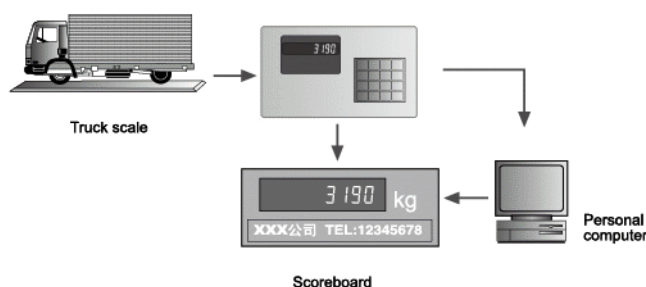
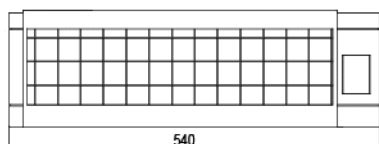

## ■ Introduction:

Auxiliary display for weighing device by viewing weighing result from long distance. Auxiliary display for weighing system by connecting with computer with matching output format. Weighing indicator should be equipped with corresponding communication interface to connect with scoreboard.

## Standard Function&Main parameters

- ◆ Dynamic scan flip-latching technology (YHL-1/3/5/5S/5K/5G)
- ◆ Static and dynamic scan flip-latching technology (YHL-8)
- ◆ High-lighted digital segment and broad eyesight
- ◆ Gross or net weight display from indicator or other output system
- ◆ Display character: 18-bit LED with character height 75mm (YHL-3/3 steel housing)
- ◆ Display character: 6-bit LED with character height 75mm (YHL-3 steel housing)
- ◆ Display character: 6-bit LED with character height 125mm (YHL-5 steel housing)
- ◆ Display character: 6-bit LED with character height 125mm (YHL-5S, character LED, water proof housing)
- ◆ Display character: 6-bit LED with character height 125mm (YHL-5G, dot LED, water proof housing)
- ◆ Display character: 6-bit LED with character height 200mm (YHL-8 steel housing)
- ◆ Display character: 6-bit LED with character height 25mm (YHL-1 steel housing)

Power: AC187-242V:49-51HZ

Communication interface: current loop way/RS232

Operating temperature: 0-40°C

Operating humidity: ≤85% RH

## Nonstandard Function( Optional, please inform sales staff if need):

- ◆ Connection to PC function  
(Output format of PC should be offered by customer)
- ◆ Connection to other indicator function  
(Corresponding manual for indicator or sample should be offered)