



Manufactured according to OIML R60 standards

Capacity from 15000 kg to 50000 kg



- 17-4 PH STAINLESS STEEL
- COMBINED ERROR $\leq \pm 0.035\%$
- IP68 PROTECTION RATING

MOUNTING KITS



CAPACITY	kg	NET WEIGHT (kg)
	15000	1.4
	30000	2.2
	50000	3.8

CERTIFICATIONS

EAC Complies with the Eurasian Customs Union standards

UK CA Equivalent of the CE marking for the United Kingdom

CERTIFICATIONS ON REQUEST

Linearity test

Ex ATEX II 1GD (zone 0-1-2-20-21-22) (**CE - UK CA**)

IECEx (zone 0-1-2-20-21-22)

EAC Ex Complies with the Eurasian Customs Union standards for use in potentially explosive atmospheres

OPTIONS ON REQUEST

DESCRIPTION



Two redundant strain gauges Wheatstone bridges (350 Ω) with two output cables; for dual safety systems

TECHNICAL FEATURES

Material	17-4 PH stainless steel		
Nominal load (E max)	15000 - 30000 - 50000 kg		
Combined error	≤ ±0.035%		
Protection rating	IP68		
Rated output	2 mV/V ±0.1%	Input resistance	700 Ω ±5
Temperature effect on zero	0.005% °C	Output resistance	700 Ω ±5
Temperature effect on span	0.005% °C	Zero balance	±1%
Compensated temperature range	-10 °C / +50 °C	Insulation resistance	>10000 MΩ
Operating temperature range	-20 °C / +70 °C	Safe overload (% of full scale)	150%
Creep at nominal load in 30 minutes	0.03%	Ultimate overload (% of full scale)	300%
Max supply voltage without damage	15 V	Deflection at nominal load	0.4 mm

ELECTRICAL CONNECTIONS

Cable length	10 m
Cable diameter	5 mm
Cores	6 x 0.14 mm ²

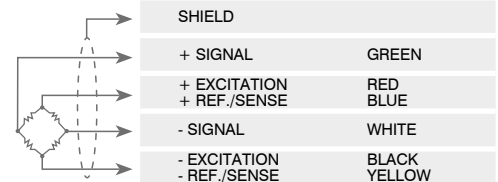

COMPLEMENTARY ACCESSORIES

	DESCRIPTION		CODE
	AISI 304 stainless steel threaded upper base for compression load cells.	M12x1.75 mm	BASESUPFIL
	AISI 304 stainless steel turned lower base for compression load cells.	Ø110x22 mm Ø140x23 mm	BINF100 BINF126
	Lower plate and turned upper base in AISI 304 stainless steel. Load cell capacity: up to 15000 kg.		BASESUP P10000
	Turned upper and lower bases in AISI 304 stainless steel. Load cell capacity: up to 15000 kg.		BASESUP BASEINF
	Lower plate and turned lower base in AISI 304 stainless steel. Load cell capacity: up to 15000 kg.		BASEINF PIASTRA200
	AISI 304 stainless steel adapter for mounting kit: - V15000 for Ø82 mm load cells - V30000 for Ø100 mm load cells - V100000 for Ø126 mm load cells		ADAT100 ADAT126 ADAT165

DIMENSIONS (mm)

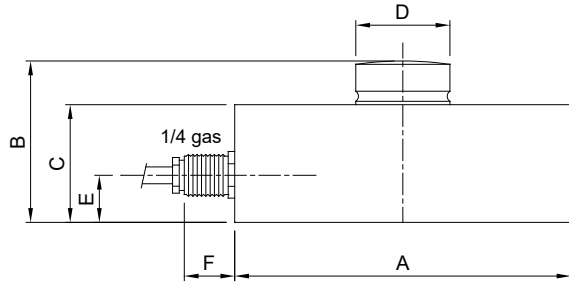

kg	15000	30000	50000
A	Ø82	Ø100	Ø126
B	44	48	54
C	32	35	40
D	Ø22	Ø28	Ø35
E	14	14	14
F	15	15	15

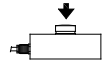

P10000

BASESUP

PIASTRA200

BASESUPFIL

BINF

	A	B	C	D
BINF100	Ø110	22	Ø102	2
BINF126	Ø140	23	Ø128	3