

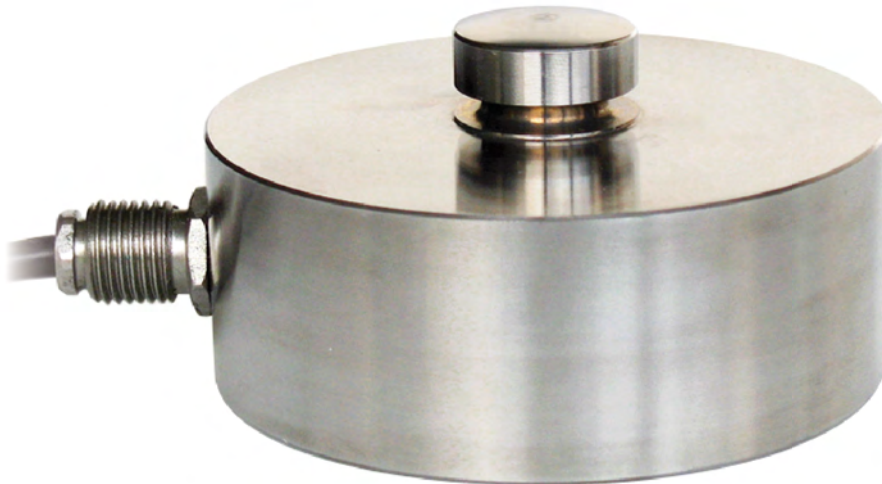

Capacity from 250 kg to 100000 kg



MOUNTING KITS







- 17-4 PH STAINLESS STEEL (on request AISI 420 stainless steel version; not OIML approved)
- COMBINED ERROR $\leq \pm 0.03\%$ (0.02% C3)
- IP68 PROTECTION RATING

CAPACITY	kg	ACCURACY CLASS				NET WEIGHT (kg)
		C2	C3			
250		-	-	-	-	1.1
500		-	-	-	-	1.1
1000		-	-	-	-	1.1
2500		•	•	•	•	1.1
5000		•	•	•	•	1.1
7500		•	•	•	•	1.1
10000		•	•	•	•	1.1
12500*		-	•	•	•	1.6
15000		-	-	-	-	2.1
30000		-	-	-	-	3.8
50000		-	-	-	-	8.6
100000		-	-	-	-	9.1

ON REQUEST

(*) Except for the capacity of 12500kg, which is already OIML R60 C3 approved

CERTIFICATIONS

-  OIML R60 C2
-  Complies with the Eurasian Customs Union standards
-  Equivalent of the CE marking for the United Kingdom
-  Complies with United Kingdom regulations for legal for trade use

CERTIFICATIONS ON REQUEST

 IP69K	Declaration of conformity + IP69K marking protection rating <i>Water protection in case of high-pressure or steam jet cleaning (test: pressurized water is sprayed from a distance of max 150 mm) Water pressure: 100 bar; temperature: 80 °C; test duration: 250 seconds (reference standard: DIN 40050-9)</i>
	Linearity test
	ATEX II 1GD (zone 0-1-2-20-21-22) (CE - UKCA)
	IECEx (zone 0-1-2-20-21-22)
	OIML R60 C3
	Complies with the Eurasian Customs Union standards for use in potentially explosive atmospheres
	Complies with the regulations of the Russian Federation for legal for trade use

TECHNICAL FEATURES

Material	17-4 PH stainless steel		
OIML R60 Accuracy class • Verification intervals	-	C2 • 2000	C3 • 3000
Nominal load (E max)	250 - 500 - 1000 - 15000 kg 30000 - 50000 - 100000 kg	2500 - 5000 kg 7500 - 10000 kg	2500 - 5000 - 7500 kg 10000 - 12500 kg
Minimum verification interval (V min)	-	E max / 15000	E max / 15000
Combined error	≤ ±0.03%	≤ ±0.03%	≤ ±0.02%
Protection rating	IP68		
Rated output	2 mV/V ±0.1%	Input resistance	700 Ω ±10
Temperature effect on zero	0.005% °C	Output resistance	700 Ω ±10
Temperature effect on span	0.003% °C	Zero balance	±1%
Temperature range OIML R60	-10 °C / +40 °C	Insulation resistance	> 10000 MΩ
Compensated temperature range	-20 °C / +70 °C	Safe overload (% of full scale)	150%
Operating temperature range	-30 °C / +90 °C	Ultimate overload (% of full scale)	300%
Creep at nominal load in 30 minutes	0.03%	Deflection at nominal load	0.4 mm
Max supply voltage without damage	15 V		



ELECTRICAL CONNECTIONS

Cable length	5 m*(250-10000 kg); 10 m (12500-100000 kg)
Cable diameter	5 mm
Cores	6 x 0.14 mm ²

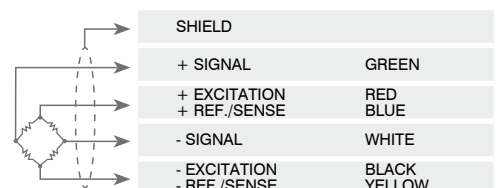



*) On request: 10 m long cable version



OPTIONS ON REQUEST

	DESCRIPTION
	10 m long cable version for 250-10000 kg capacities
 AISI 420	AISI 420 stainless steel load cell version (not OIML approved)
	Two redundant strain gauges Wheatstone bridges (350 Ω) with two output cables; for dual safety systems

COMPLEMENTARY ACCESSORIES

	DESCRIPTION		CODE
	AISI 304 stainless steel threaded upper base for compression load cells.	M12x1.75 mm	BASESUPFIL
	AISI 304 stainless steel turned lower base for compression load cells.	Ø110x22 mm Ø140x23 mm Ø180x23 mm	BINF100 BINF126 BINF165
	Lower plate and turned upper base in AISI 304 stainless steel. Load cell capacity: up to 12500 kg.		BASESUP P10000
	Turned upper and lower bases in AISI 304 stainless steel. Load cell capacity: up to 12500 kg.		BASESUP BASEINF
	Lower plate and turned lower base in AISI 304 stainless steel. Load cell capacity: up to 12500 kg.		BASEINF PIASTRA200

DIMENSIONS (mm)

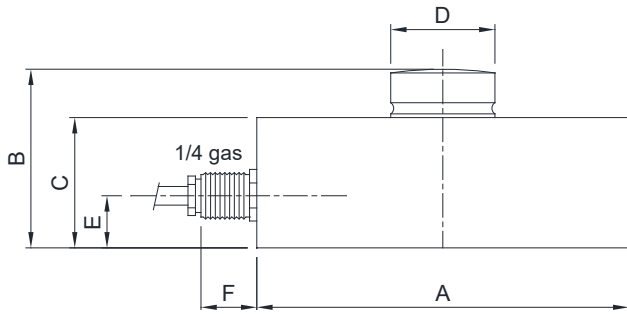

kg	250	15000	30000	50000
A	Ø82	Ø100	Ø126	Ø164
B	44	48	54	80
C	32	35	40	60
D	Ø22	Ø28	Ø35	Ø60
E	14	14	14	26
F	15	15	15	15

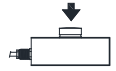

P10000

BASESUP

BASEINF

PIASTRA200

BASESUPFIL

BINF

	A	B	C	D
BINF100	Ø110	22	Ø102	2
BINF126	Ø140	23	Ø128	3
BINF165	Ø180	23	Ø167	3